



---

A.D. 1852 . . . . . N° 602.

---

S P E C I F I C A T I O N

OF

JOHN CHUBB.

---

LOCKS.

---

L O N D O N :

PRINTED BY GEORGE E. EYRE AND WILLIAM SPOTTISWOODE,  
PRINTERS TO THE QUEEN'S MOST EXCELLENT MAJESTY :

PUBLISHED AT THE QUEEN'S PRINTING OFFICE, EAST HARDING STREET,  
NEAR FLEET STREET.

*Price 8½d.*

1854.

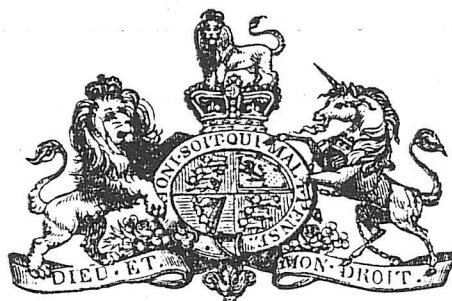

---

A.D. 1852 . . . . . N° 602.

---

**Locks.**

**LETTERS PATENT** to John Chubb, of St. Paul's Church Yard, in the City of London, for the Invention of "**IMPROVEMENTS IN Locks.**"

Sealed the 17th January 1853, and dated the 1st November 1852.

**PROVISIONAL SPECIFICATION** left by the said John Chubb at the Office of the Commissioners of Patents, with his Petition, on the 1st November 1852.

I, JOHN CHUBB, of St. Paul's Church Yard, in the City of London,  
5 do hereby declare the nature of the said Invention for "**IMPROVEMENTS IN Locks**" to be as follows :—

These improvements consist of arranging the tumblers and apparatus in order to prevent the lock being acted on, by putting pressure on the bolt and feeling the tumblers separately. The pressure causes the bolt  
10 and the tumbler to be locked into the stump, which is made with interlocking parts corresponding with like parts in the tumblers.



---

*Chubb's Improvements in Locks.*

---

**SPECIFICATION** in pursuance of the conditions of the Letters Patent, filed by the said John Chubb in the Great Seal Patent Office on the 30th April 1853.

**TO ALL TO WHOM THESE PRESENTS SHALL COME, I, JOHN CHUBB**, of Saint Paul's Church Yard, in the City of London, 5 send greeting.

**WHEREAS** Her most Excellent Majesty Queen Victoria, by Her Letters Patent, bearing date the First day of November, in the year of our Lord One thousand eight hundred and fifty-two, in the sixteenth year of Her reign, did, for Herself, Her heirs and succes- 10 sors, give and grant unto me, the said John Chubb, Her special licence that I, the said John Chubb, my executors, administrators, and assigns, or such others as I, the said John Chubb, my executors, administrators, and assigns, should at any time agree with, and no others, from time to time and at all times thereafter during the term 15 therein expressed, should and lawfully might make, use, exercise, and vend, within the United Kingdom of Great Britain and Ireland, the Channel Islands, and Isle of Man, an Invention for "**IMPROVEMENTS IN LOCKS**," upon the condition (amongst others) that I, the said John Chubb, by an instrument in writing under my hand and seal, should 20 particularly describe and ascertain the nature of the said Invention, and in what manner the same was to be performed, and cause the same to be filed in the Great Seal Patent Office within six calendar months next and immediately after the date of the said Letters Patent.

**NOW KNOW YE**, that I, the said John Chubb, do hereby declare 25 the nature of the said Invention, and in what manner the same is to be performed, to be particularly described and ascertained in and by the following statement thereof (that is to say):

These improvements consist of arranging the tumblers and apparatus in order to prevent the lock being acted on, by putting pressure on the 30 bolt and feeling the tumblers separately. The pressure causes the bolt and the tumbler to be locked into the stump, which is made with interlocking parts corresponding with like parts in the tumblers. And in order that my Invention may be more fully understood I will proceed to describe the Drawings hereunto annexed.



---

*Chubb's Improvements in Locks.*

---

Sheet 1, shows several views of a lock having my improvements applied thereto.

Sheet 2, shows similar views of another lock constructed according to my Invention.

- 5 The object of these improvements is, with a view to render the picking of a lock made according thereto impossible.

To enable me to describe the mode of action of the several parts, I will first mention that in order to pick locks having tumblers it has been the practice of skilful persons to press back the bolt in such  
10 manner that when the tumblers are severally raised by the picklock or instrument used, the parts of the tumblers so raised shall permit the stump on the bolt to enter and pass through the spaces of the tumblers, and thus, by continuing the pressure on the bolt until all of the tumblers shall have been moved sufficiently, the bolt may be allowed  
15 to pass. Now with my improvements this mode of picking the lock is frustrated, for should the tumblers be raised by any instrument other than a proper key, a spring catch, hereafter described, descends immediately on the partial sliding back of the bolt, and enters and locks into a recess formed in the bolt, and the tumblers also lock into the stamp  
20 on the bolt.

Figure 1, shows the bolt as thrown forward or locked; Figure 2, shows the same with the tumblers raised by a picklock or other instrument during pressure on the bolt  $a$ ; and Figure 3, shows the position the parts assume if an attempt is made to pick the lock.  $a$ , is the bolt,  
25 which differs only from those now in use by its having the recess  $a^1$ , formed in it. The stump  $a^2$ , of the bolt  $a$ , I form with a recess  $a^3$ , as shown, the sides of such recess  $a^3$ , acting as teeth to enter the false notches  $b^1$ ,  $b^1$ , of the tumblers  $b$ ,  $b$ , as is shewn in Figure 3.  $c$ , is a spring, having at one end a catch  $c^1$ , which enters the recess  $a^1$ , of the  
30 bolt  $a$ , in the event of any attempt being made to pick the lock by pressing back the bolt. When moving the bolt  $a$ , backwards or forwards by a suitable key, the spring catch  $c^1$ , is prevented from descending into the recess  $a^1$ , by the projecting parts  $b^3$ , on the upper sides of the tumblers  $b$ .

- 35 In Sheet 2, of the Drawings another form of lock is shewn, similar



---

*Chubb's Improvements in Locks.*

---

in its principle of action, but in addition to the improvements already described the bolt *a*, has a recess *a*<sup>4</sup>, *a*<sup>4</sup>, above and below the ordinary slot formed to receive the stamp *a*<sup>5</sup>, on to which the tumblers are placed. The purpose of these additional recesses in the bolt *a*, is, that when an attempt is made to pick the lock, the pressure back of the bolt would 5 cause the bolt to move a little so as to cause the square portion of the pin or stump *a*<sup>5</sup>, to enter one of the recesses *a*<sup>4</sup>, *a*<sup>4</sup>, and thus offer an additional security against any attempt made to pick the lock by forcing back the bolt and acting on the tumblers in succession.

Having thus described the nature of my Invention, and the manner 10 of performing the same, I would have it understood that I do not confine myself to the details, as the forms of the parts may be varied without departing from my Invention; but what I claim is, the combining of the parts of locks as herein described.

In witness whereof, I, the said John Chubb, have hereunto set 15 my hand and seal, this Thirtieth day of April, in the year of our Lord One thousand eight hundred and fifty-three.

JOHN CHUBB. (L.S.)

Witness,

FRED<sup>k</sup> HARRIS.

20

---

LONDON:

Printed by GEORGE EDWARD EYRE and WILLIAM SPOTTISWOODE,  
Printers to the Queen's most Excellent Majesty. 1854.

12 JU 55

the bolt a,

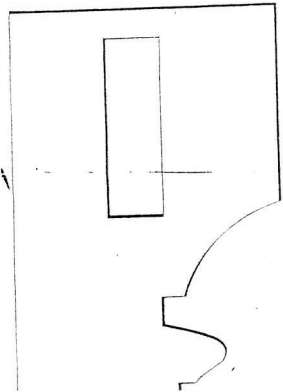

Edge View

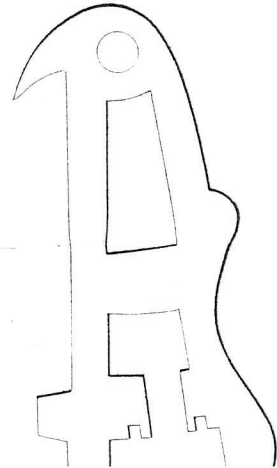

Edge View.



The tumblers shown separately.

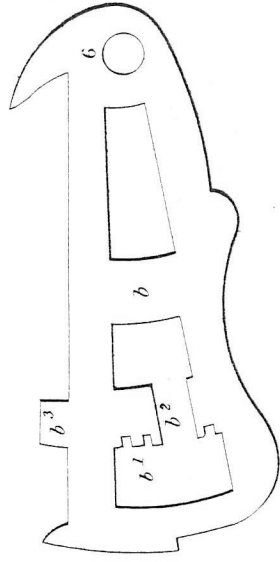
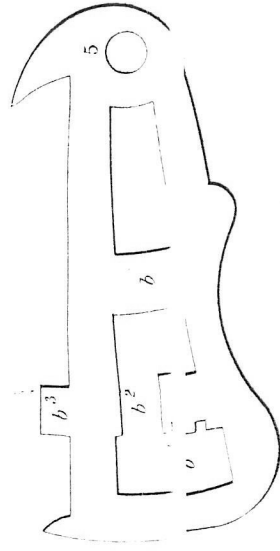
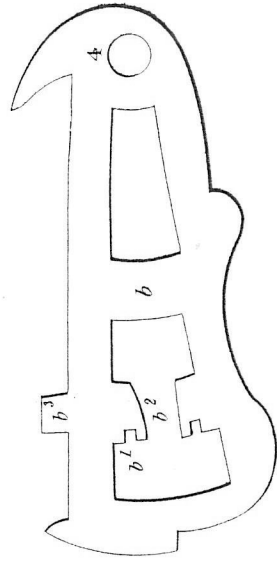
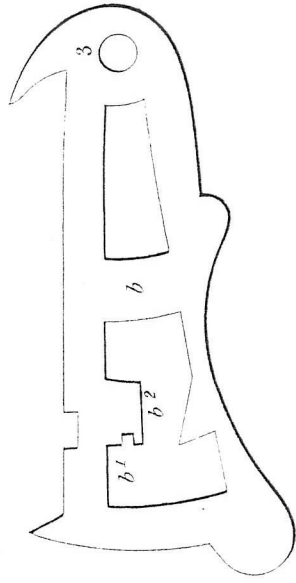
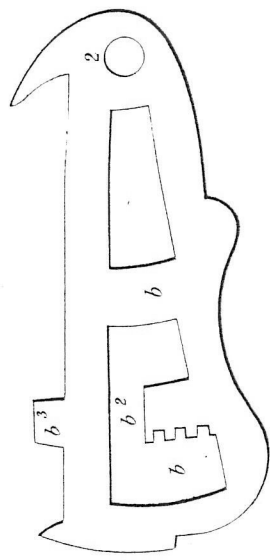

the lock complete.

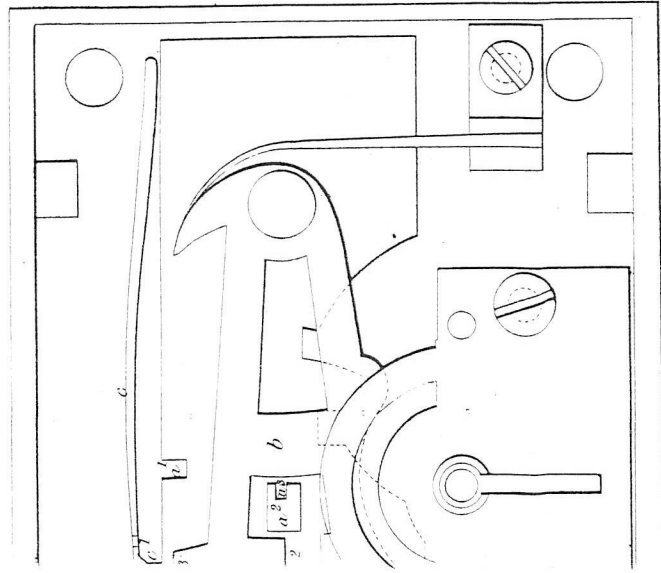

Separate views of the bolt a,  
Side view

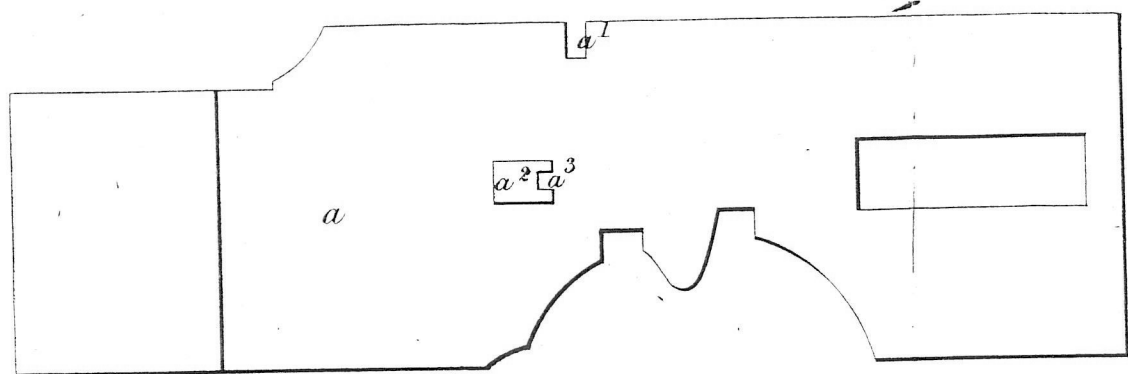

Edge View

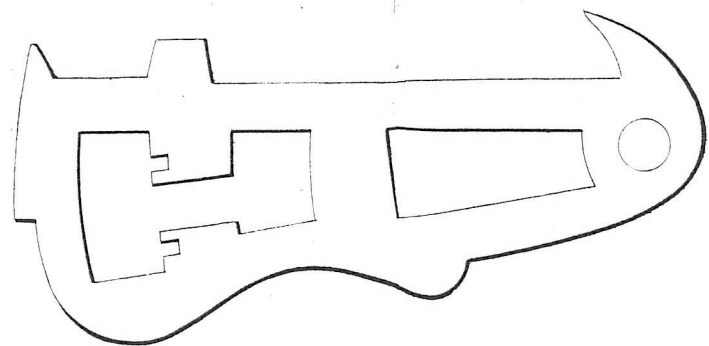
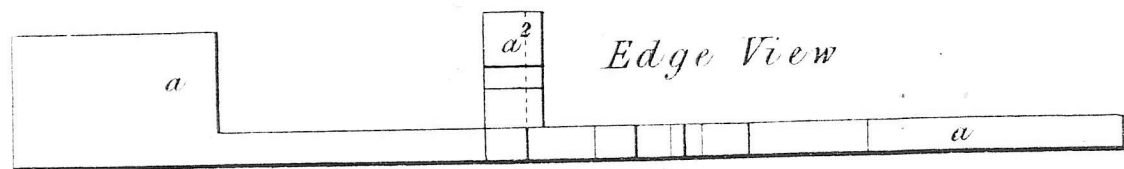

Edge View.

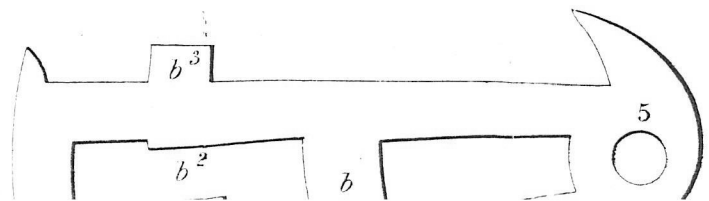
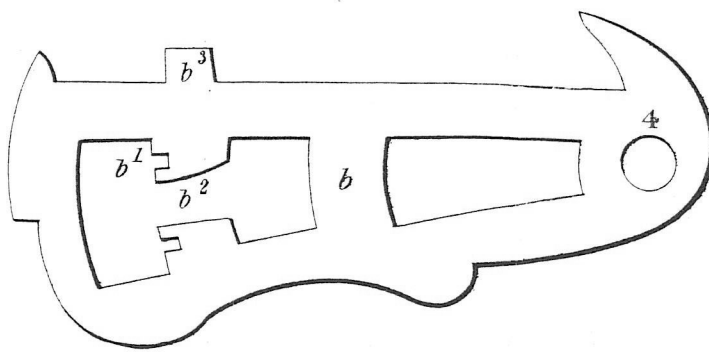
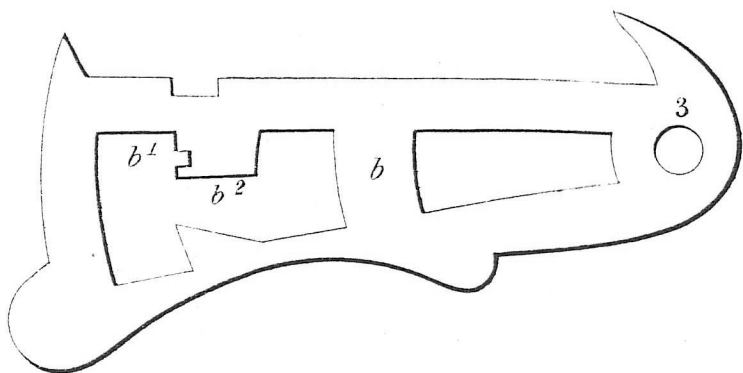
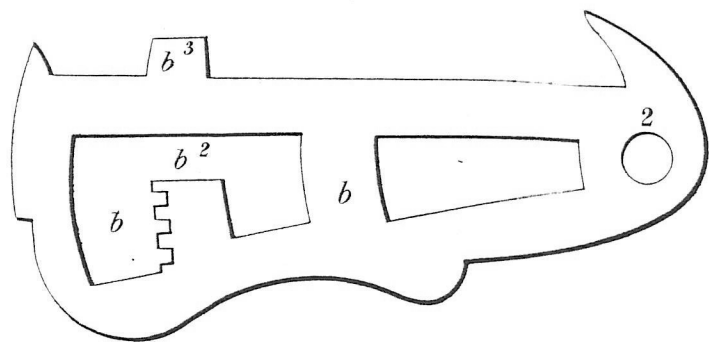

the tumblers shown separately.



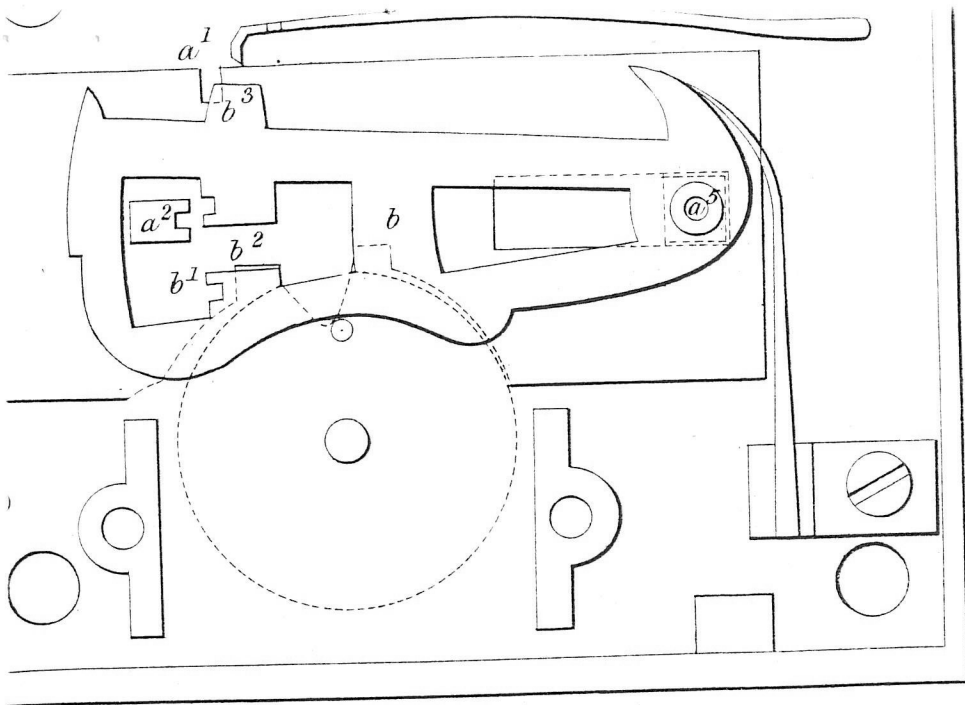
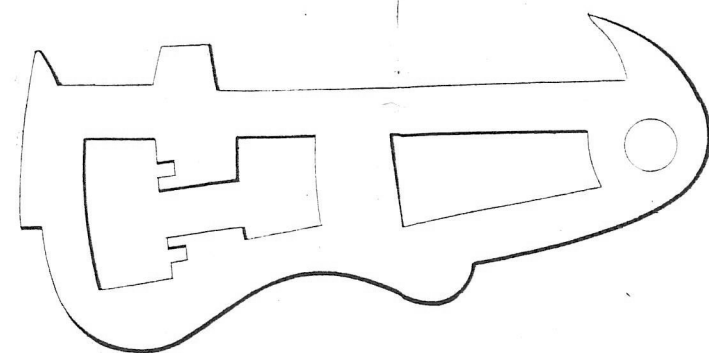
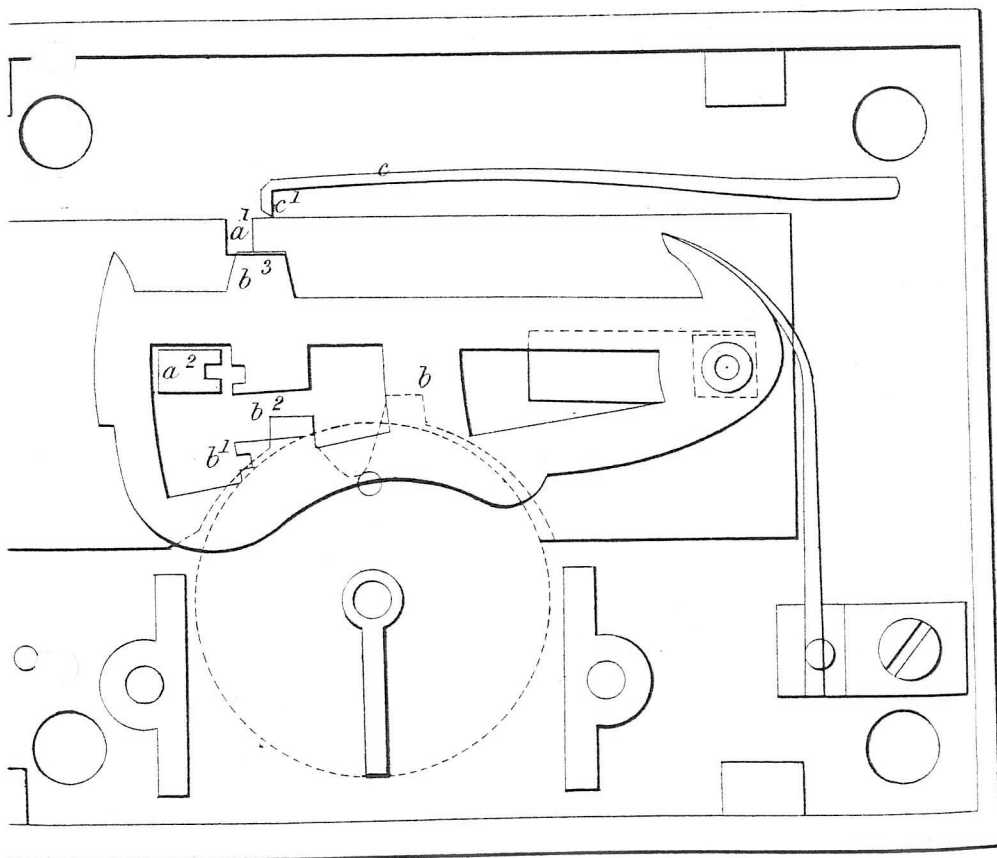
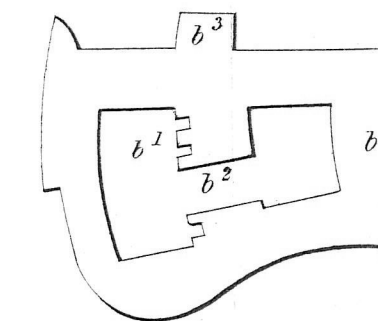
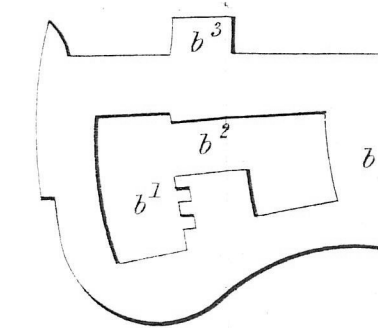
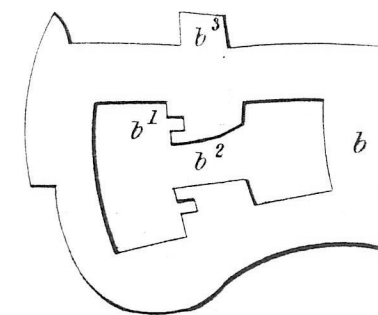
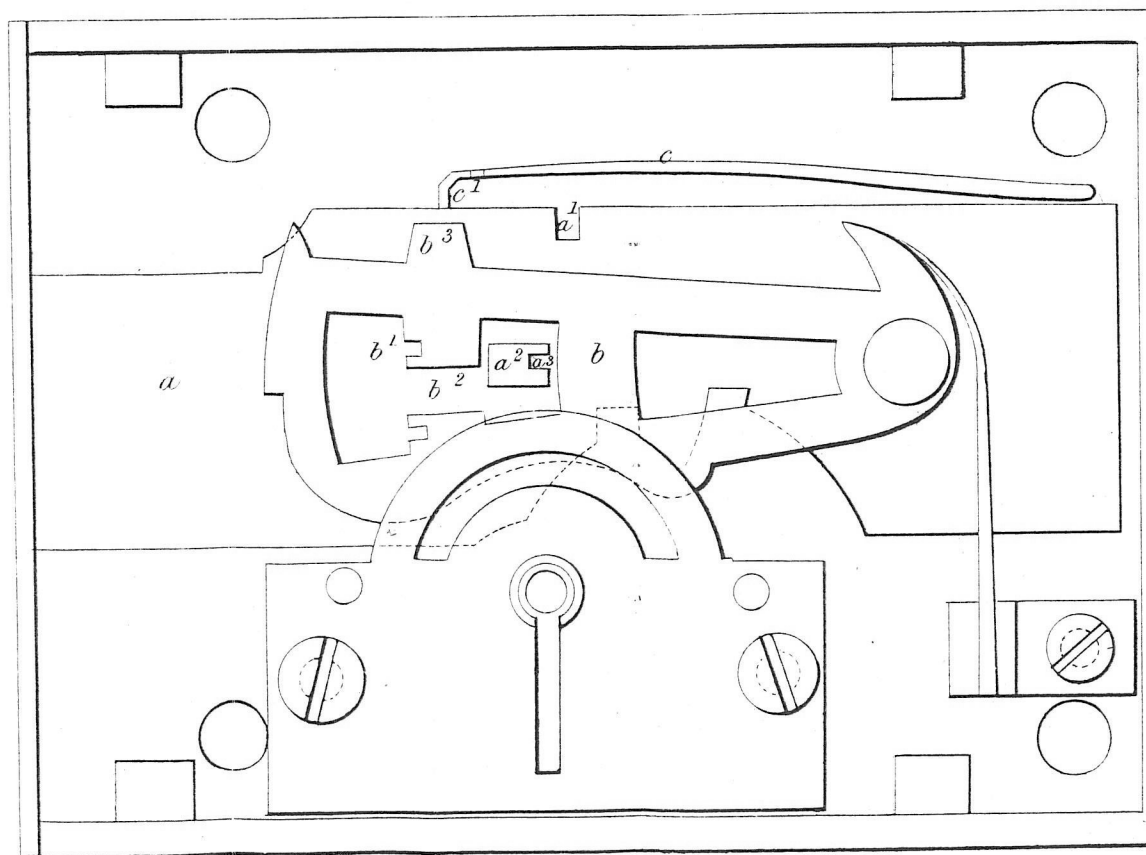

FIG. 1.



Edge View.

View of the lock complete.



The tumblers shown separately

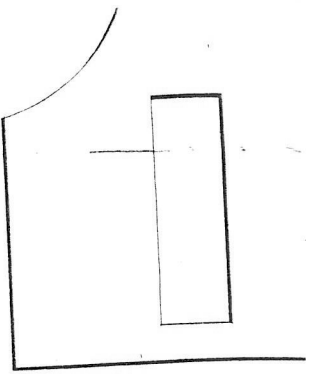

Top View

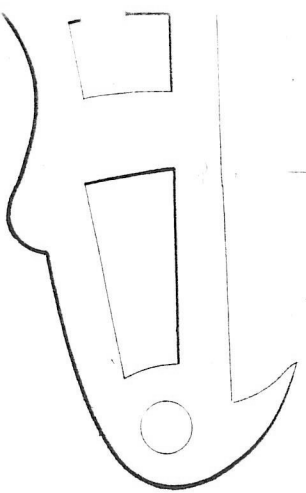

Edge View.



The lock complete.

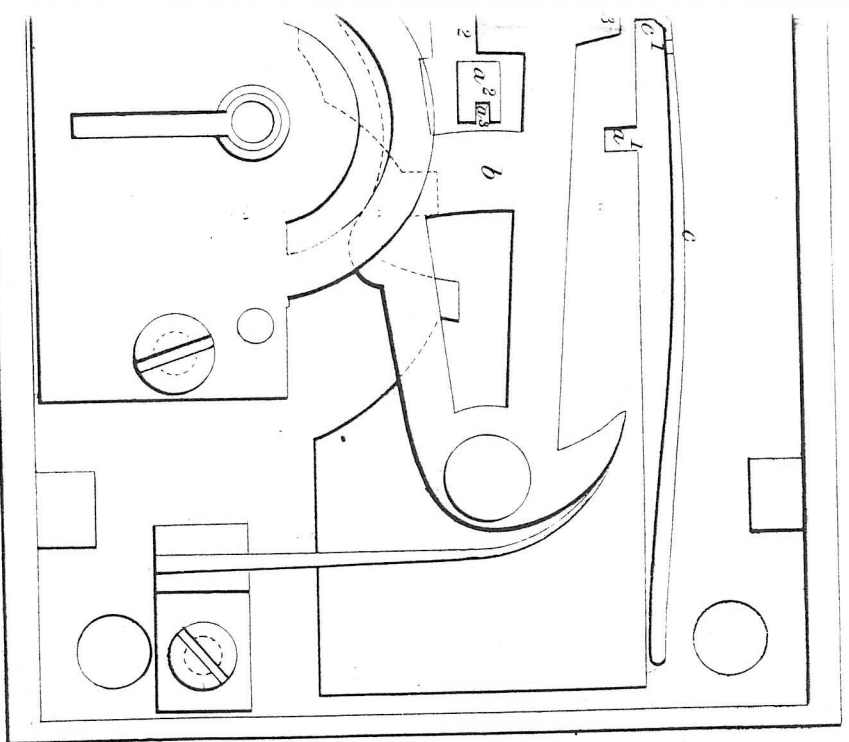

The tumblers shown separately.

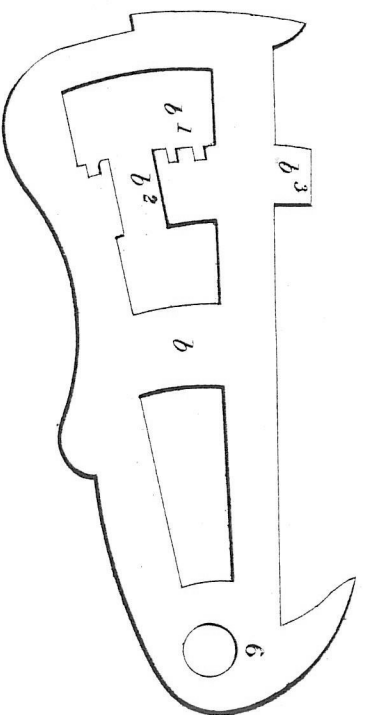
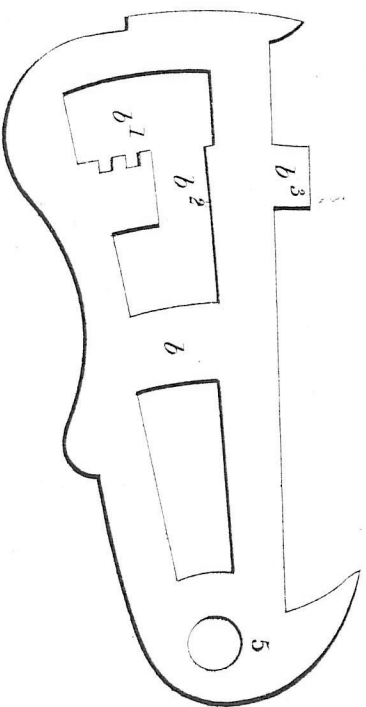
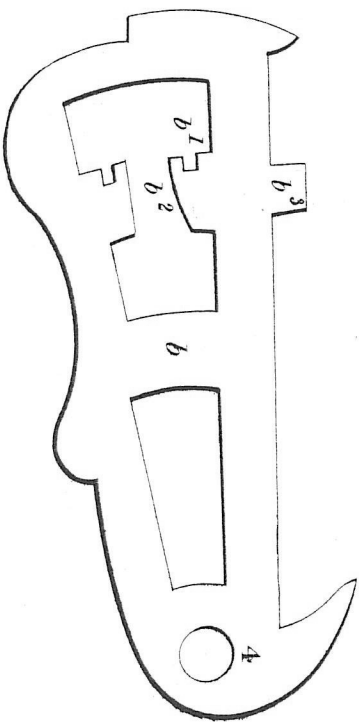
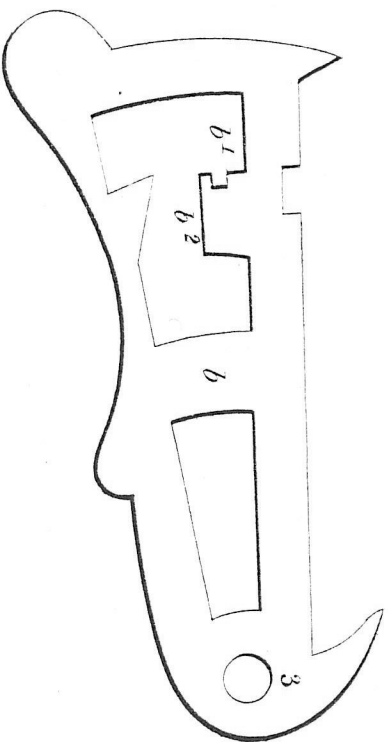
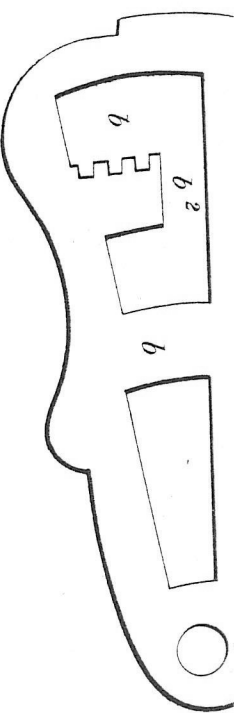

FIG. 3.

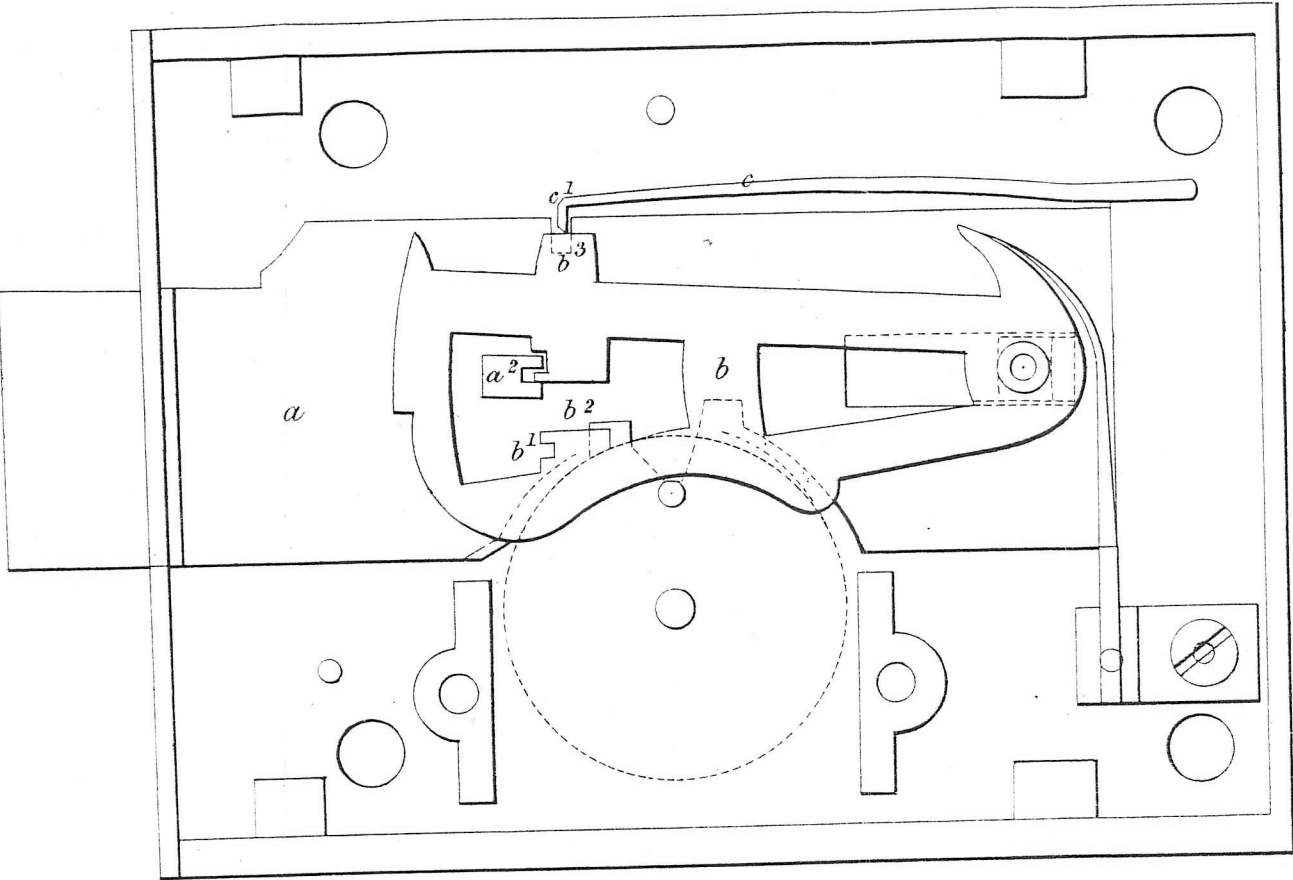
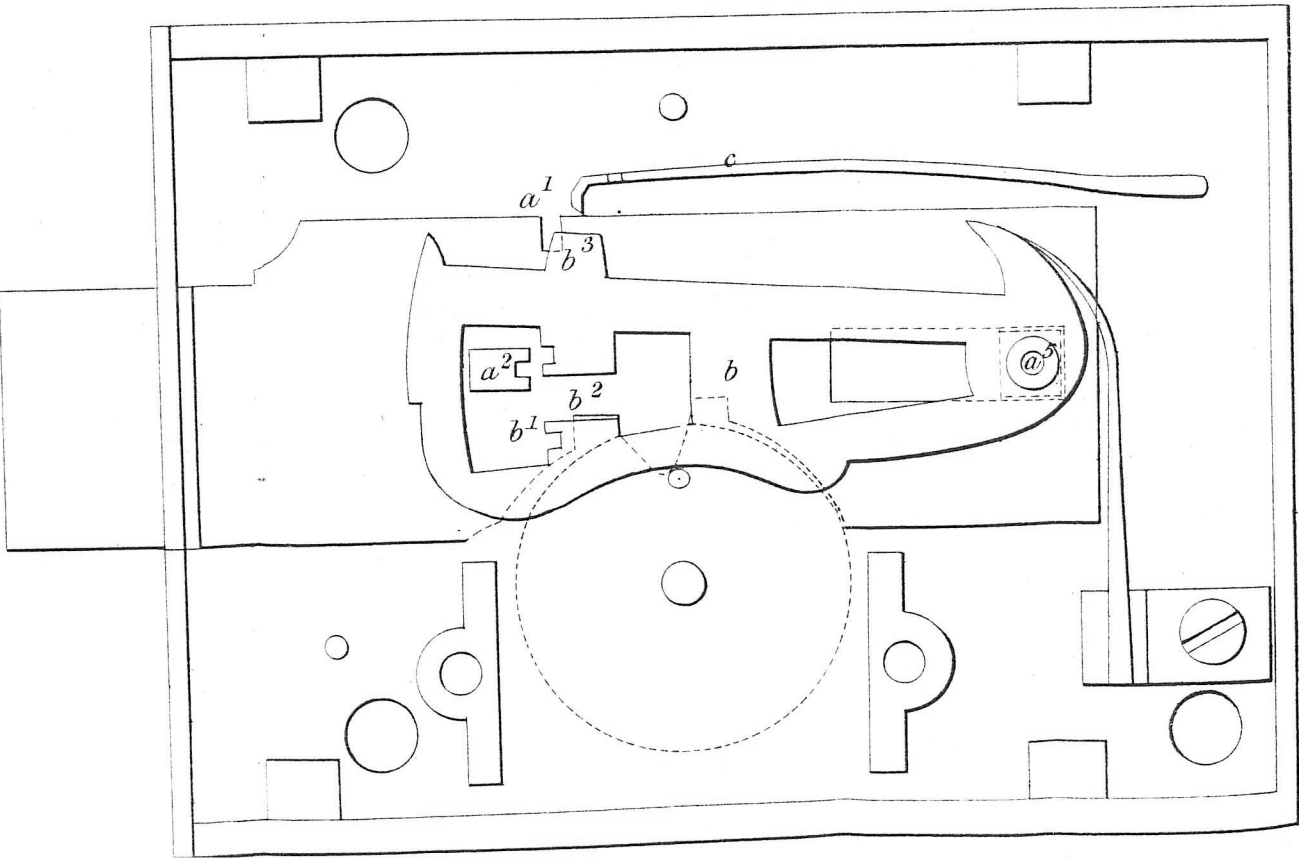
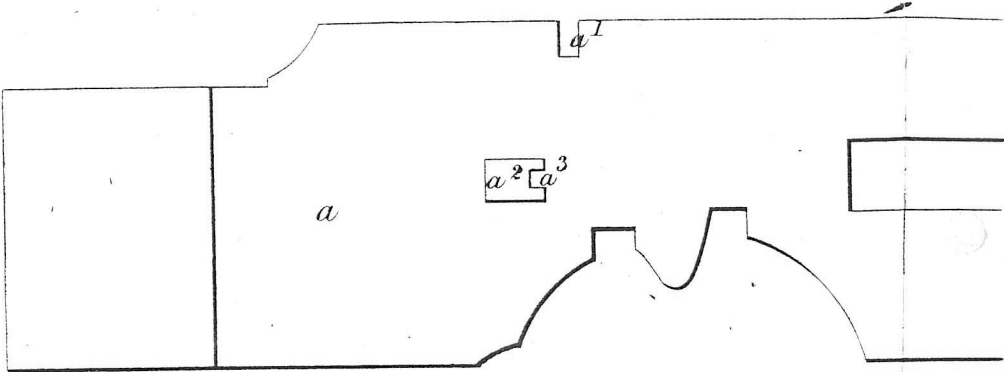

FIG. 2.



Separate views of the bolt a,  
Side view



Edge View

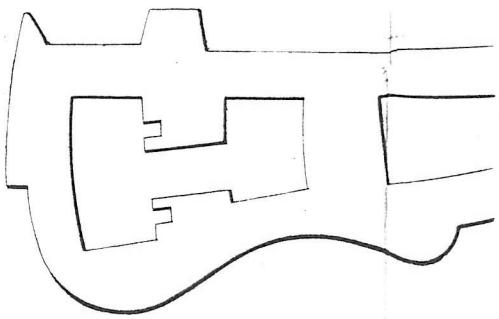
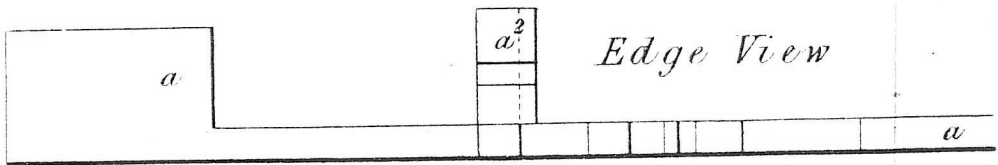

Edge View.



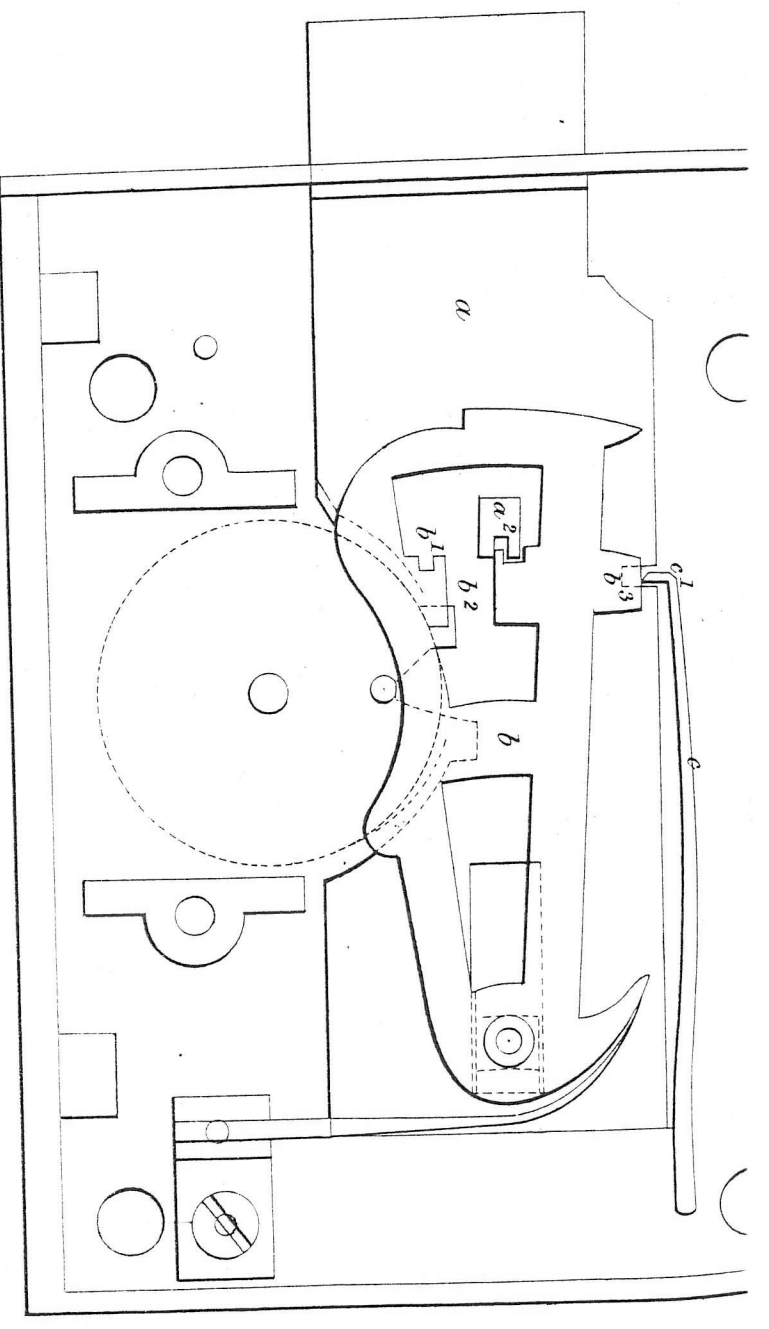

FIG. 2.

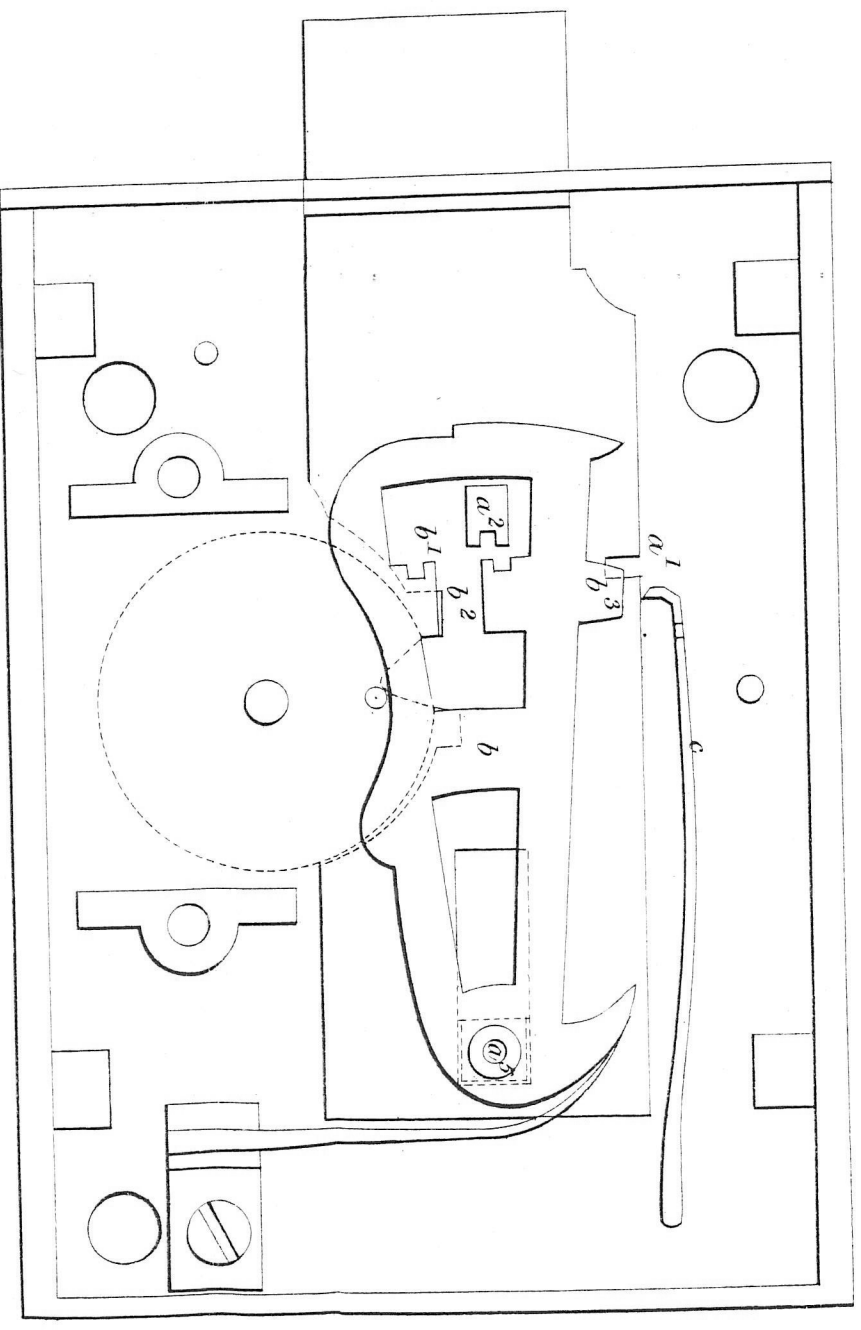
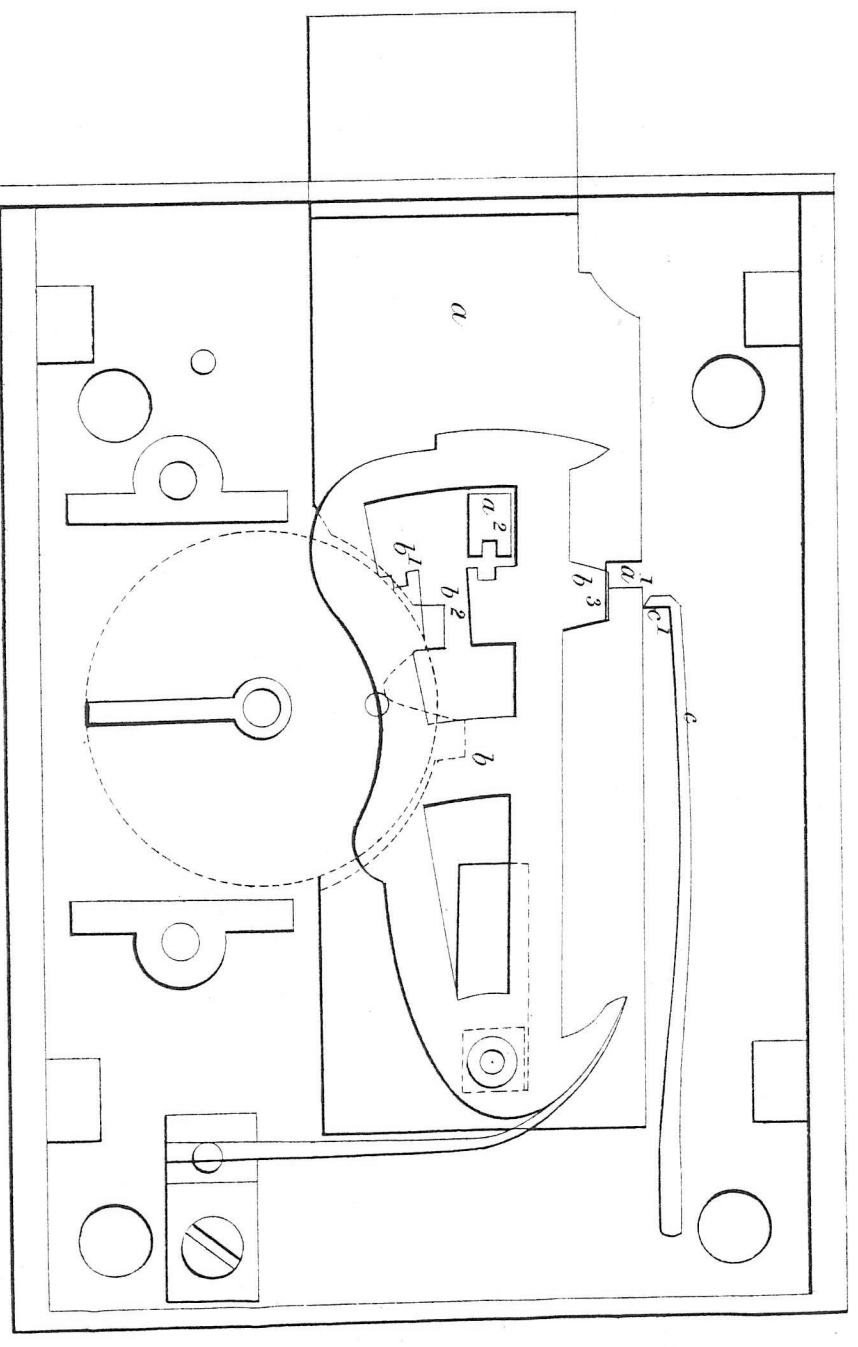

FIG. 1.



A.D 1852, NOVEMBER 1. N°602.  
CHUBB'S SPECIFICATION.

(2 SHEETS.)

SHEET 2.

FIG. 1.

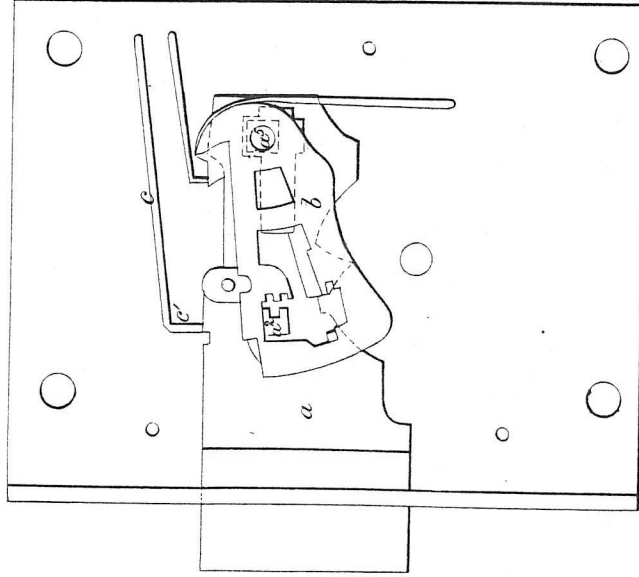

The back plate and pin *a*<sup>5</sup>.

The bolt *a* shown separately.

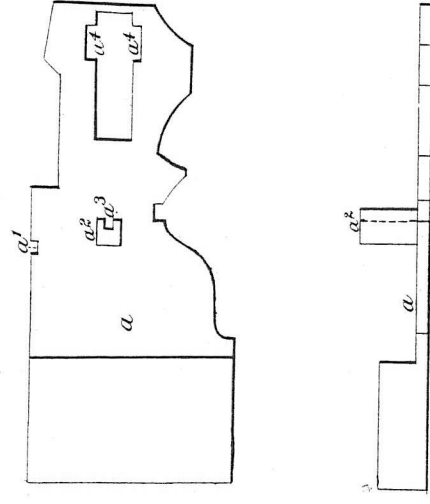
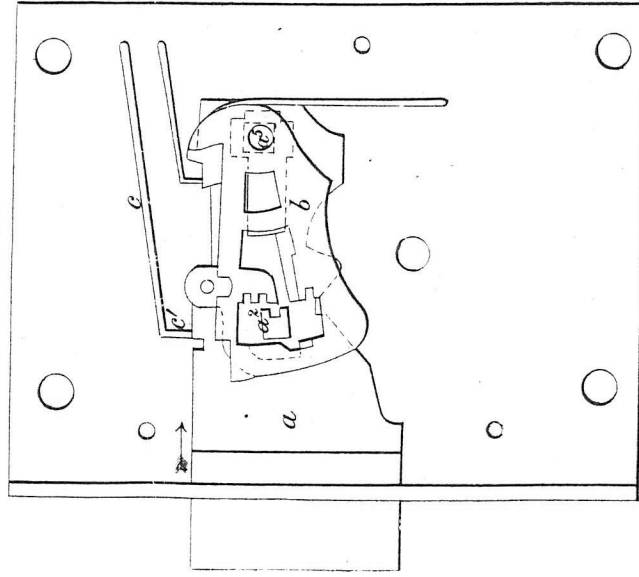

FIG. 2.



The bolt *a* shown in its place.

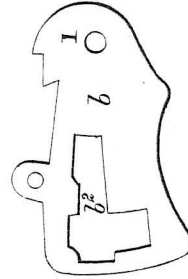
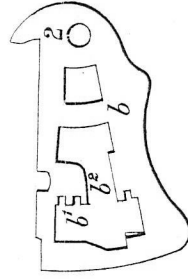
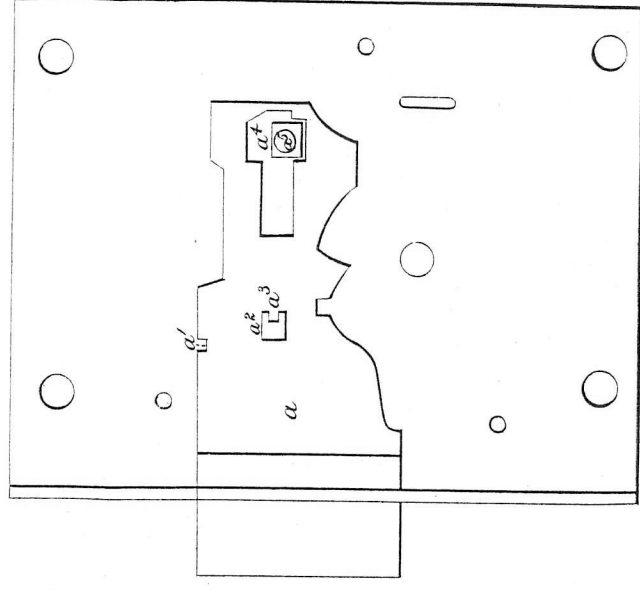
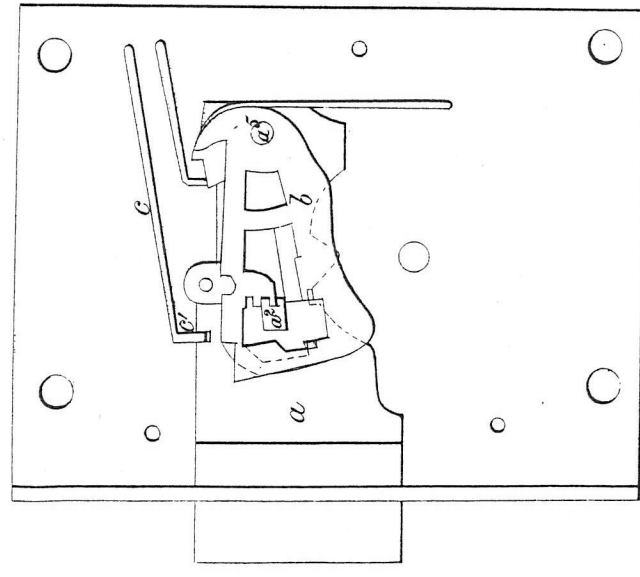
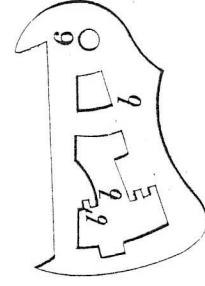
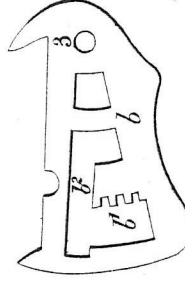
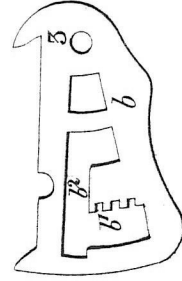
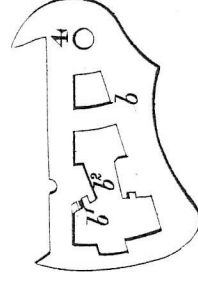

FIG. 3.



The tumblers *b* shown separately.



The Filed Drawing is colored.